

SOUTHGATE 1

- 61,700 square feet
- Completed October 1998
- Typical Bay Size: 4,800 square feet (40' x 120')
- 40' x 40' Column Spacing
- Bays designed to accommodate 1 dock-high, front-load doors and 1 personnel door with storefront entrance at grade
- 22' clear ceiling height
- 120/240, three phase
- Built-up roof system, 24' bar joist
- Fully sprinklered
- 4:1000 parking



102 West Pineloch Street

PMC PINELOCH
MANAGEMENT
CORPORATION

Post Office Box 568367
Orlando, Florida 32856-8367
Contact: Greg Wilson
407-859-3550
greg@pineloch.com
Website: www.pineloch.com

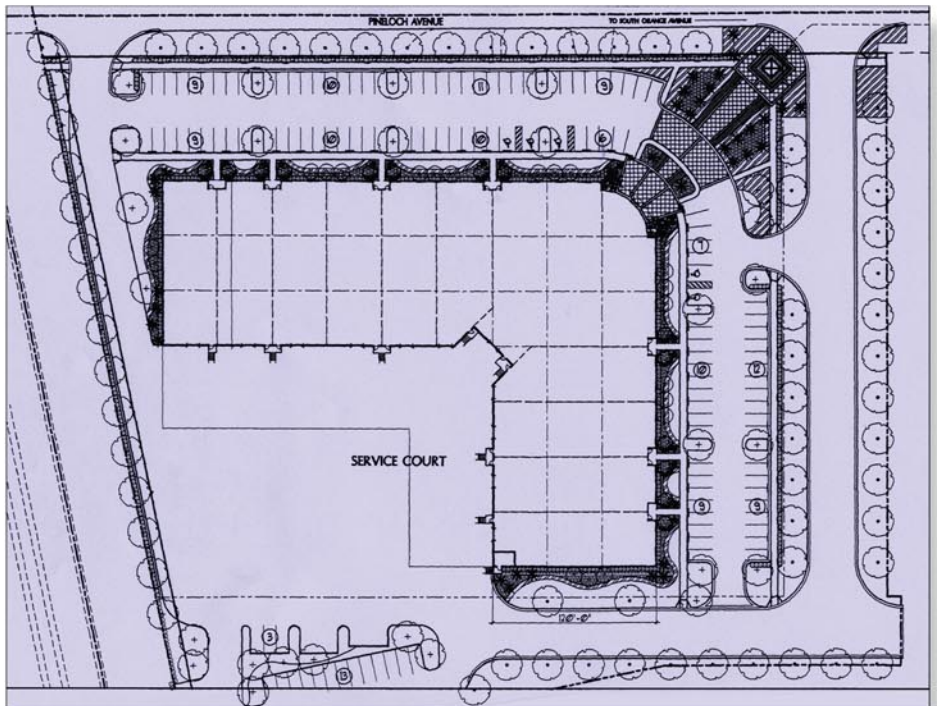

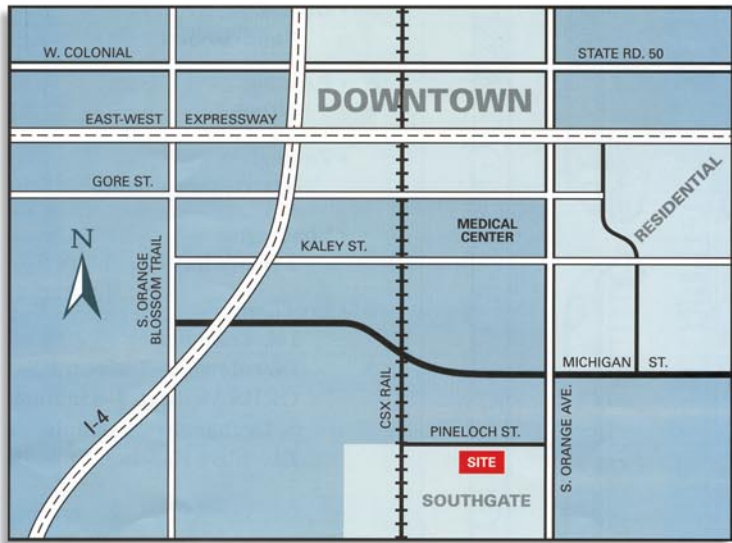

Southgate is a mixed-use development that includes Class A office space, light industrial, bulk warehouse space, and retail. The connectivity and location of Southgate provides accessibility to I-4, the Turnpike and the Beltway System, and is located within minutes of the Orlando CBD and the International Airport.

